

SECTION A-A  
SCALE 1 : 2.75

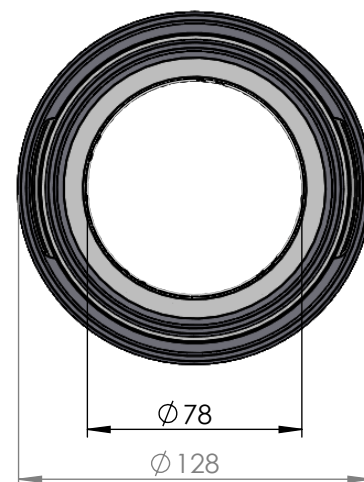

ITEM NO.	PART NUMBER	PART NAME	Expl /QTY
1	M35-107	Inner house 4S070-4S079	1
2	O-ring	$\varnothing 100 \times 3,5\text{mm}$	1
3	M03-213	Delrin Lockring $\varnothing 98,5 \times \varnothing 81 \times 1,75\text{mm}$	2
4	M05-188	L-ring $\varnothing 79 \varnothing 81.5 \varnothing 95$	2
5	M01-308	Roller $\varnothing 8.5 \times 57\text{mm}$	32
6	M11-103	Ball 4S060-4SF079	1
7	O-ring	$\varnothing 115 \times 3.5$	1
8	M09-105	Alu lockring $\varnothing 100,5 \times \varnothing 109,5$	1
9	M31-106	Outer house 4S060-4S079	1
10	M07-157	Washer $\varnothing 78.5 \varnothing 109$	1

DWG NR / NAME:

## 4S078 / Self-aligning lower bearing

BATCH NR:

PROJECT:

Shaft  $\varnothing 78\text{mm}$ , max working load 4900kg

REKV.NR / ORDRE NR:

DATE:

27-08-2009

NAME:

JR

SCALE / PAPER:

1:3 / A4

MATERIAL:

WEIGHT:

g

LOCATION:

REV:

ORDRE DATO:

LEV.DATO:

*Jefa Rudder*  
SYSTEMS

JEFA MARINE A/S  
NIMBUSVEJ 2  
2670 GREVE, DENMARK

Tlf: +45 4615 5210 & Fax: +45 4615 5208  
Email: info@jefa.com www.jefa.com

: /