

SECTION A-A
SCALE 1 : 4

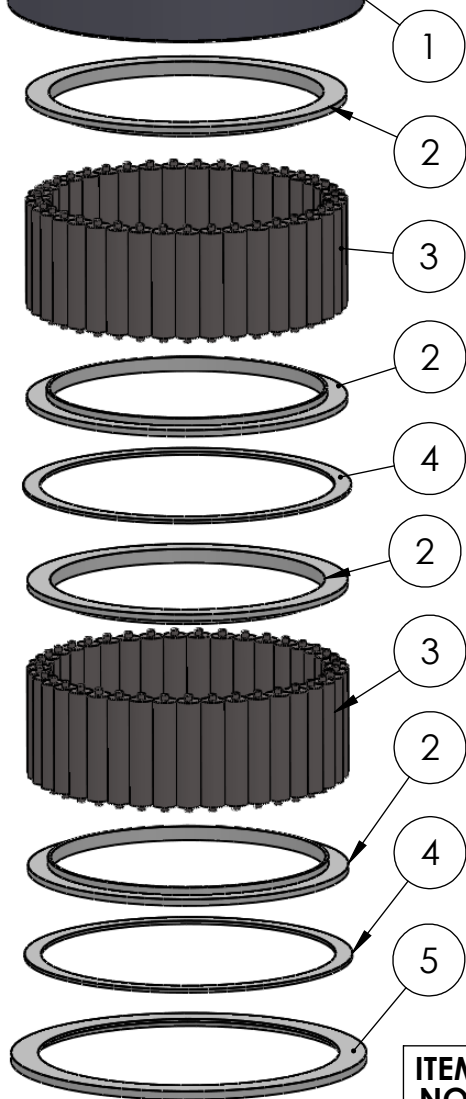
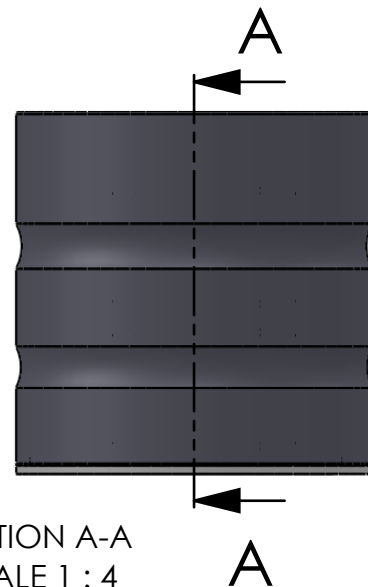

ITEM NO.	PART NUMBER	PART NAME	QTY.
1	M21-125	Rollerbearing $\phi 145 - \phi 154\text{mm}$	1
2	M05-341	L-ring, delrin $\phi 145 \times \phi 170 \times 7,5\text{mm}$	4
3	M01-372	Roller $\phi 12.5 \times 57\text{mm}$	78
4	M03-310	Delrin Lockring $\phi 173,5 \times \phi 156 \times 1,75\text{mm}$	2
5	M07-233	Washer $\phi 159 \times \phi 188 \times 4,5\text{mm}$	1

DWG NR / NAME:

41145 / Lower roller bearing

BATCH NR:

PROJECT:

Shaft $\phi 145\text{mm}$, max working load 19200kg

REKV.NR / ORDRE NR:

DATE:

27.07.2016

NAME:

JR

SCALE / PAPER:

1:4 / A4

MATERIAL:

WEIGHT:

g

LOCATION:

ORDRE DATO:

MODIFY DATE:

: /

REV:

LEV.DATO:

Jefa Rudder
SYSTEMS

JEFA MARINE A/S
NIMBUSVEJ 2
2670 GREVE, DENMARK

Tlf: +45 4615 5210 & Fax: +45 4615 5208
Email: info@jefa.com www.jefa.com