

A

B

C

D

E

F

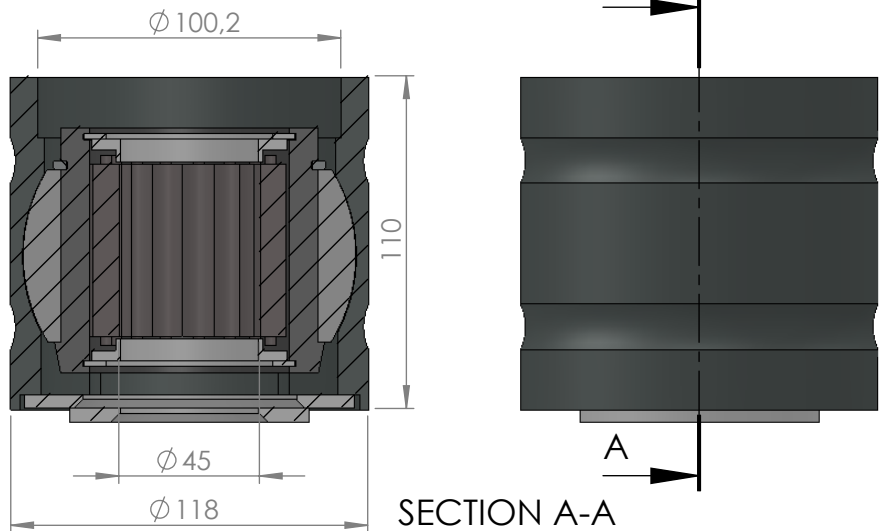
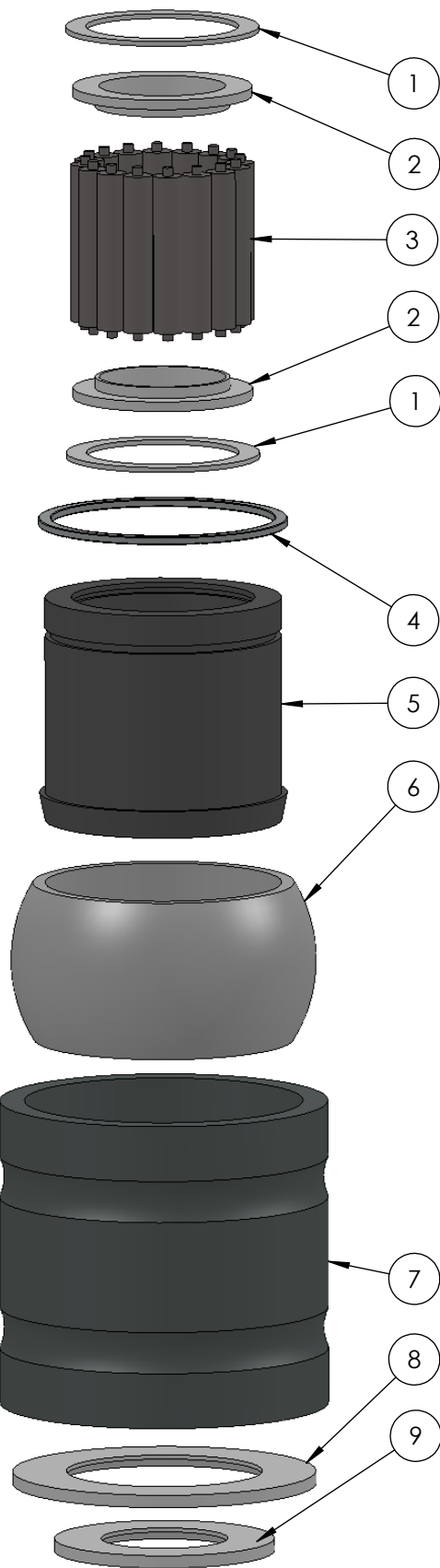

ITEM NO.	PART NUMBER	PART NAME	QTY.
1	M03-197	Delrin Lockring $\phi 69,5 \times \phi 55 \times 1,75\text{mm}$	2
2	M05-119	L-ring $\phi 45 \times \phi 65 \times 7,5$	2
3	M01-340	Roller $\phi 10.5 \times 57\text{mm}$	16
4	M09-101	Alu lockring $\phi 80.5 \times \phi 89.5$	1
5	M27-101	Inderhus for 43040-43050	1
6	M15-101	Ball for 43040-43060	1
7	M25-101	Yderhus for 43040-43060	1
8	M07-146	Washer $\phi 70.5 \phi 109$	1
9	M07-110	Washer $\phi 45.5 \times \phi 79$	1

DWG NR / NAME:

43045 / Self-aligning roller bearing

BATCH NR:

PROJECT:

Shaft $\phi 45$ max working load 3400kg

REKV.NR / ORDRE NR:

DATE:
25-01-2010NAME:
JRSCALE / PAPER:
1:2.5 / A4MATERIAL:
WEIGHT: g

LOCATION:

ORDRE DATO:

MODIFY DATE:

: /

REV:

LEV.DATO:

Jefa Rudder
SYSTEMS

JEFA MARINE A/S
NIMBUSVEJ 2
2670 GREVE, DENMARK

Tlf: +45 4615 5210 & Fax: +45 4615208
Email: info@jefa.com www.jefa.com