

SECTION A-A
SCALE 1 : 3.5

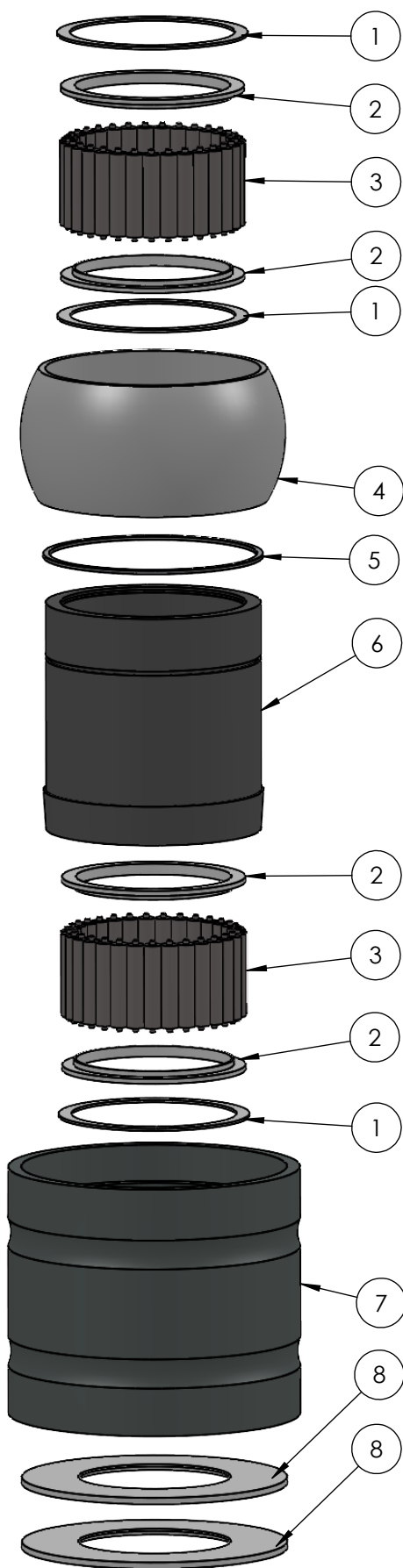

| ITEM NO. | PART NUMBER | PART NAME | QTY. |
|----------|-------------|---|------|
| 1 | M03-237 | Delrin Lockring $\phi 129,5 \times \phi 112 \times 1,75\text{mm}$ | 3 |
| 2 | M05-257 | L-ring $\phi 105 \phi 108.5 \phi 125$ | 4 |
| 3 | M01-356 | Roller $\phi 11.5 \times 57\text{mm}$ | 62 |
| 4 | M15-130 | Ball for 43101-43120 | 1 |
| 5 | M09-115 | Alu lockring $\phi 140.5 \times \phi 149.5$ | 1 |
| 6 | M27-135 | Inderhus for 43101-44110 | 1 |
| 7 | M25-115 | Yderhus for 43101-43120 | 1 |
| 8 | M07-187 | Washer, delrin $\phi 103,5 \times \phi 180 \times 4,5\text{mm}$ | 2 |

DWG NR / NAME:

43103 / Self-aligning roller bearing

BATCH NR:

PROJECT:

Shaft $\phi 103\text{mm}$, max working load 12800kg

REKV.NR / ORDRE NR:

DATE:

07-01-2010

NAME:

JR

SCALE / PAPER:

1:3,5 / A4

MATERIAL:

WEIGHT:

g

LOCATION:

REV:

ORDRE DATO:

LEV.DATO:

MODIFY DATE:

: /

Jefa Rudder
SYSTEMS

JEFA MARINE A/S
NIMBUSVEJ 2
2670 GREVE, DENMARK

Tlf: +45 4615 5210 & Fax: +45 4615 5208
Email: info@jefa.com www.jefa.com