

SECTION A-A
SCALE 1 : 4

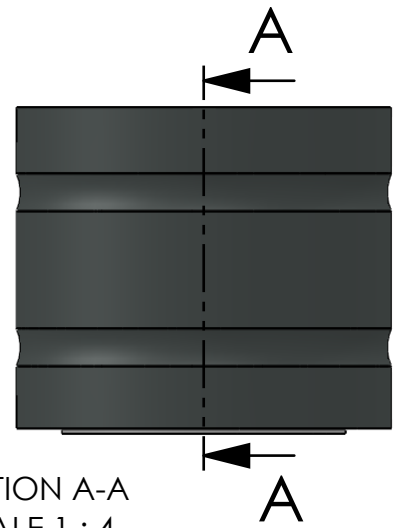

ITEM NO.	PART NUMBER	PART NAME	QTY.
1	M03-237	Delrin Lockring $\varnothing 129,5 \times \varnothing 112 \times 1,75\text{mm}$	3
2	M05-266	L-ring $\varnothing 109 \varnothing 111.5 \varnothing 125$	4
3	M01-308	Roller $\varnothing 8.5 \times 57\text{mm}$	86
4	M15-130	Ball for 43101-43120	1
5	M09-115	Alu lockring $\varnothing 140.5 \times \varnothing 149.5$	1
6	M27-135	Inderhus for 43101-44110	1
7	M25-115	Yderhus for 43101-43120	1
8	M07-198	Washer, delrin $\varnothing 110,5 \times \varnothing 180 \times 4,5\text{mm}$	1
9	M07-196	Washer, delrin $\varnothing 110,5 \times \varnothing 150 \times 4,5\text{mm}$	1

DWG NR / NAME:

43109 / Self-aligning roller bearing

BATCH NR:

PROJECT:

Shaft $\varnothing 109\text{mm}$, max working load 14000kg

REKV.NR / ORDRE NR:

DATE:
07-01-2010

NAME:
JR

SCALE / PAPER:
1:10 / A4

MATERIAL:
WEIGHT: g

LOCATION:

ORDRE DATO:

MODIFY DATE:

: /

REV:

LEV.DATO:

Jefa Rudder
SYSTEMS

JEFA MARINE A/S
NIMBUSVEJ 2
2670 GREVE, DENMARK

Tlf: +45 4615 5210 & Fax: +45 4615208
Email: info@jefa.com www.jefa.com