

SECTION A-A  
SCALE 1 : 4

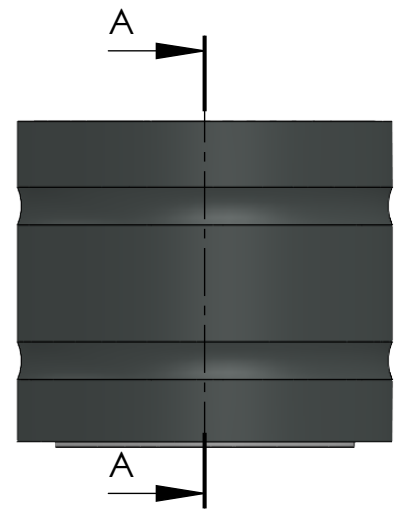

ITEM NO.	PART NUMBER	PART NAME	QTY.
1	M03-275	Delrin Lockring $\varnothing 138,5 \times \varnothing 121 \times 1,75\text{mm}$	3
2	M05-287	L-ring $\varnothing 119 \varnothing 121.5 \varnothing 135$	4
3	M01-316	Roller $\varnothing 9.0 \times 57\text{mm}$	88
4	M15-130	Ball for 43101-43120	1
5	M09-115	Alu lockring $\varnothing 140.5 \times \varnothing 149.5$	1
6	M27-145	Inderhus for 43111-44120	1
7	M25-115	Yderhus for 43101-43120	1
8	M07-205-B	Washer, delrin $\varnothing 118,5 \times \varnothing 180 \times 4,5\text{mm}$	1
9	M07-206	Washer $\varnothing 119.5 \varnothing 158$	1

DWG NR / NAME:

**43118 / Self-aligning roller bearing**

BATCH NR:

PROJECT:

Shaft  $\varnothing 118\text{mm}$ , max working load 15300kg

REKV.NR / ORDRE NR:

DATE:  
07-01-2010

NAME:  
JR

SCALE / PAPER:  
1:4 / A4

MATERIAL:  
WEIGHT: g

LOCATION:  
REV:

ORDRE DATO:

LEV.DATO:

MODIFY DATE:  
: /

*Jefa Rudder*  
SYSTEMS

JEFA MARINE A/S  
NIMBUSVEJ 2  
2670 GREVE, DENMARK

Tlf: +45 4615 5210 & Fax: +45 4615 5208  
Email: info@jefa.com www.jefa.com