

SECTION B-B  
SCALE 1 : 3

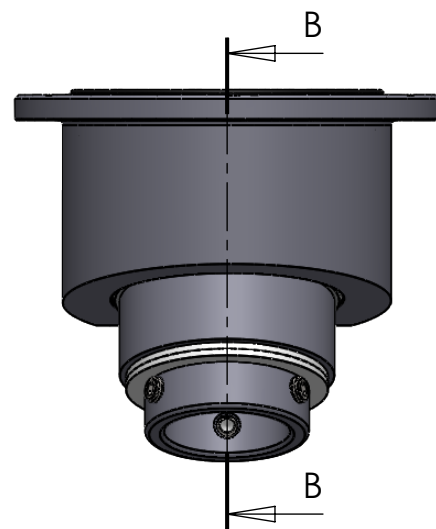

ITEM NO.	PART NUMBER	PART NAME	QTY.
1	M43-118	Cover with M118	1
2	M36-503	Outer house 4S050Z-20	1
3	M37-099	Inner house 4S050Z	1
4	M11-101	Ball 4S040-4SF059	1
5	M09-101	Alu lockring $\varnothing 80.5 \times \varnothing 89.5$	1
6	M05-134	L-ring $\varnothing 50 \varnothing 53.5 \varnothing 75$	2
7	M03-201	Delrin Lockring $\varnothing 78,5 \times \varnothing 61 \times 1,75\text{mm}$	2
8	M41-510	5mm delrin ball	44
9	M01-272	Roller $\varnothing 12.5 \times 44\text{mm}$	15
10	O-ring	$\varnothing 110 \times 2.5$	1
11	M39-050	Hanger $\varnothing 50$	1
12	DIN916-10x10	Socket set Screw M10x10mm	3
13	M03-605	Delrin Lockring $\varnothing 80 \times \varnothing 65,7 \times 2,75\text{mm}$	1
14	M03-610	Delrin Lockring $\varnothing 80 \times \varnothing 61 \times 2,75\text{mm}$	1

DWG NR / NAME:

**4S050Z-20 / self-aligning rollerbearing**

PROJECT:

Shaft  $\varnothing 50\text{mm}$ . 5-21° alignment. Max working load 2600kg

DATE:

14-02-2017

NAME:

KJ

SCALE / PAPER:

1:4 / A4

MATERIAL:

WEIGHT:

g

LOCATION:

REV:

BATCH NR:

REKV.NR / ORDRE NR:

ORDRE DATO:

LEV.DATO:

*Jefa Rudder*  
S Y S T E M S

JEFA MARINE A/S  
NIMBUSVEJ 2  
2670 GREVE, DENMARK

Tlf: +45 4615 5210 & Fax: +45 46155208  
Email: info@jefa.com www.jefa.com

MODIFY DATE:

: /