

SECTION A-A
SCALE 1 : 4

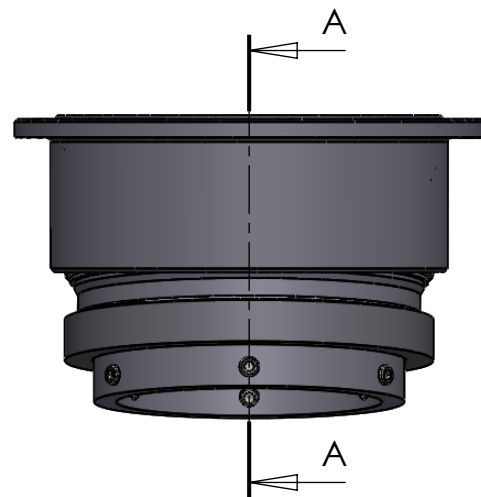

ITEM NO.	PART NUMBER	PART NAME	QTY.
1	M43-198	Cover with M198	1
2	O-ring	$\varnothing 190 \times 2,5$	1
3	M36-525	Outer house 4S140Z 4S145Z 4S150Z 4S155Z	1
4	M03-305	Delrin Lockring $\varnothing 168,5 \times \varnothing 151$ $\times 1,75\text{mm}$	2
5	M05-335	L-ring $\varnothing 140 \varnothing 143.5 \varnothing 165$	2
6	M01-372	Roller $\varnothing 12.5 \times 57\text{mm}$	38
7	M37-125	Inner house 4S140Z	1
8	M11-111	Ball 4S140-4SF159	1
9	M09-125	Alu lockring $\varnothing 180.5 \times \varnothing 189.5$	1
10	M41-510	5mm delrin ball	210
11	M39-130	Hanger $\varnothing 140$	1
12	Platic hub	Plastic innerligner 140 x 1mm plate	1
13	DIN916-10x10	Socket set Screw M10x10mm	6
14	M41-150	Omløber $\varnothing 140\text{mm}$	1

DWG NR / NAME:

4S140Z / self-aligning rollerbearing

BATCH NR:

PROJECT:

Shaft $\varnothing 140\text{mm}$ 0-6° alignment. Max working load 8800kg

REKV.NR / ORDRE NR:

DATE:

27-09-2010

NAME:

JR

SCALE / PAPER:

1:5 / A4

MATERIAL:

WEIGHT:

g

LOCATION:

REV:

ORDRE DATO:

LEV.DATO:

MODIFY DATE:

: /

Jefa Rudder
SYSTEMS

JEFA MARINE A/S
NIMBUSVEJ 2
2670 GREVE, DENMARK

Tlf: +45 4615 5210 & Fax: +45 4615208
Email: info@jefa.com www.jefa.com