

SECTION A-A
SCALE 1 : 2.75

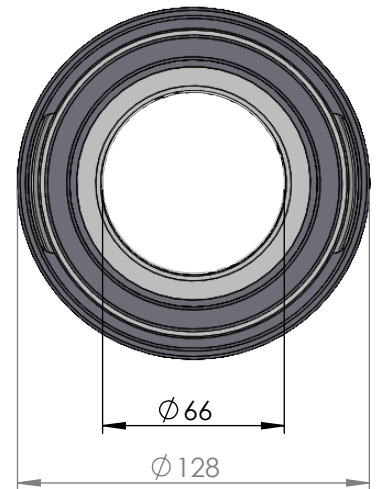

ITEM NO.	PART NUMBER	PART NAME	Expl / QTY
1	M35-105	Inner house 4S060-4S069	1
2	O-ring	$\varnothing 90 \times 2,5\text{mm}$	1
3	M03-207	Delrin Lockring $\varnothing 88,5 \times \varnothing 71 \times 1,75\text{mm}$	2
4	M05-167	L-ring $\varnothing 67 \varnothing 69.5 \varnothing 85$	2
5	M01-224	Roller $\varnothing 9.5 \times 44\text{mm}$	25
6	M11-103	Ball 4S060-4S079	1
7	O-ring	$\varnothing 100 \times 2.5$	1
8	M09-105	Alu lockring $\varnothing 100,5 \times \varnothing 109,5$	1
9	M31-106	Outer house 4S060-4S079	1
10	M07-139	Washer $\varnothing 66.5 \varnothing 99$	1

DWG NR / NAME:

4S066 / Self-aligning lower bearing

BATCH NR:

PROJECT:

Shaft $\varnothing 66\text{mm}$, max working load 4200kg

REKV.NR / ORDRE NR:

DATE:

27-08-2009

NAME:

JR

SCALE / PAPER:

1:3 / A4

MATERIAL:

WEIGHT:

g

LOCATION:

REV:

ORDRE DATO:

LEV.DATO:

MODIFY DATE:

: /

Jefa Rudder
SYSTEMS

JEFA MARINE A/S
NIMBUSVEJ 2
2670 GREVE, DENMARK

Tlf: +45 4615 5210 & Fax: +45 46155208
Email: info@jefa.com www.jefa.com