

SECTION A-A
SCALE 1 : 3

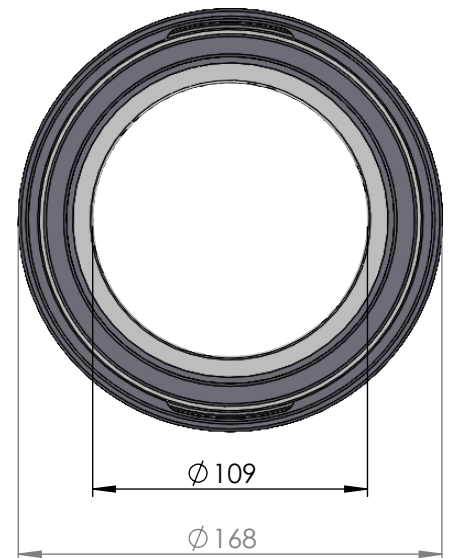
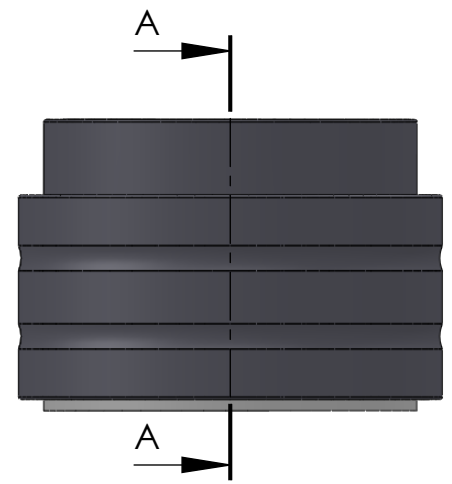

| ITEM NO. | PART NUMBER | PART NAME | Expl /QTY |
|----------|-------------|---|-----------|
| 1 | M35-113 | Inner house 4S100-4S109 | 1 |
| 2 | O-ring | $\phi 130 \times 2.5\text{mm}$ | 1 |
| 3 | M03-235 | Delrin Lockring $\phi 128,5 \times \phi 111 \times 1,75\text{mm}$ | 2 |
| 4 | M05-266 | L-ring $\phi 109 \phi 111.5 \phi 125$ | 2 |
| 5 | M01-301 | Roller $\phi 8.0 \times 57\text{mm}$ | 46 |
| 6 | M11-107 | Ball 4S100-4S119 | 1 |
| 7 | O-ring | $\phi 140 \times 2.5\text{mm}$ | 1 |
| 8 | M09-115 | Alu lockring $\phi 140.5 \times \phi 149.5$ | 1 |
| 9 | M31-116 | Outer house 4S100-4S119 | 1 |
| 10 | M07-197 | Washer $\phi 110.5 \phi 148$ | 1 |

DWG NR / NAME:

4S109 / Self-aligning lower bearing

BATCH NR:

PROJECT:

Shaft $\phi 109\text{mm}$, max working load 6800kg

REKV.NR / ORDRE NR:

DATE:

27-08-2009

NAME:

JR

SCALE / PAPER:

1:3.5 / A4

MATERIAL:

WEIGHT:

g

LOCATION:

ORDRE DATO:

MODIFY DATE:

: /

REV:

LEV.DATO:

Jefa Rudder
SYSTEMS

JEFA MARINE A/S
NIMBUSVEJ 2
2670 GREVE, DENMARK

Tlf: +45 4615 5210 & Fax: +45 46155208
Email: info@jefa.com www.jefa.com