

SECTION A-A
SCALE 1 : 3.5

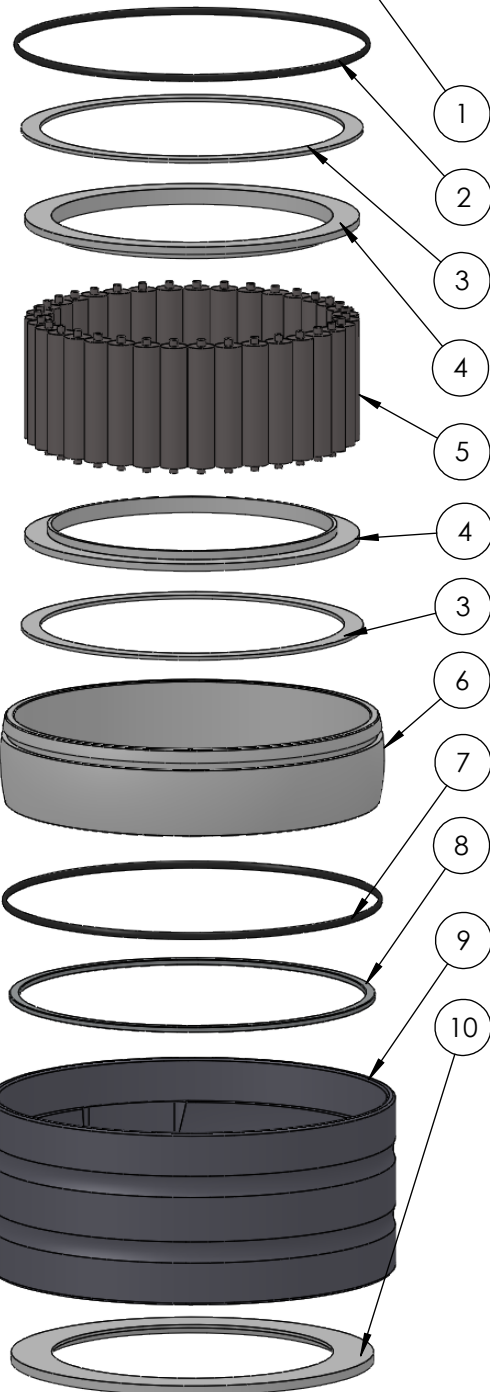
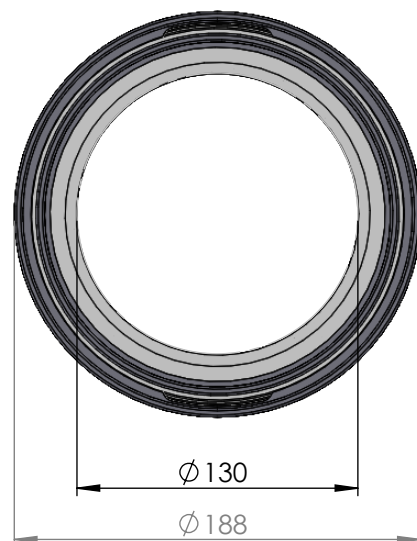

| ITEM NO. | PART NUMBER | PART NAME | QTY |
|----------|-------------|---|-----|
| 1 | M35-119 | Inner house 4S130-4S139 | 1 |
| 2 | O-ring | $\varnothing 150 \times 2.5\text{mm}$ | 1 |
| 3 | M03-295 | Delrin Lockring $\varnothing 158,5 \times \varnothing 141 \times 1,75\text{mm}$ | 2 |
| 4 | M05-317 | L-ring, delrin $\varnothing 130 \times \varnothing 155 \times 7,5\text{mm}$ | 2 |
| 5 | M01-372 | Roller $\varnothing 12.5 \times 57\text{mm}$ | 35 |
| 6 | M11-109 | Ball 4S120-4S139 | 1 |
| 7 | O-ring | $\varnothing 160 \times 2.5\text{mm}$ | 1 |
| 8 | M09-120 | Alu lockring $\varnothing 160.5 \times \varnothing 169.5$ | 1 |
| 9 | M31-121 | Outer house 4S120-4S139 | 1 |
| 10 | M07-221 | Washer $\varnothing 130.5 \varnothing 168$ | 1 |

DWG NR / NAME:

4S130 / Self-aligning lower bearing

BATCH NR:

PROJECT:

Shaft $\varnothing 130\text{mm}$, max working load 8400kg

REKV.NR / ORDRE NR:

DATE:

27-08-2009

NAME:

JR

SCALE / PAPER:

1:4 / A4

MATERIAL:

WEIGHT:

g

LOCATION:

REV:

ORDRE DATO:

LEV.DATO:

MODIFY DATE:

: /

Jefa Rudder
SYSTEMS

JEFA MARINE A/S
NIMBUSVEJ 2
2670 GREVE, DENMARK

Tlf: +45 4615 5210 & Fax: +45 46155208
Email: info@jefa.com www.jefa.com