

A

SECTION A-A
SCALE 1 : 3.5

B

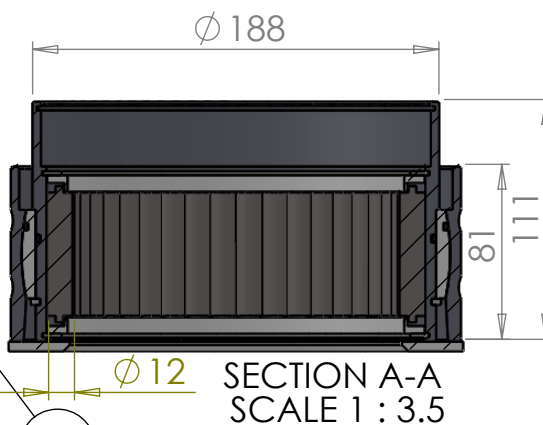
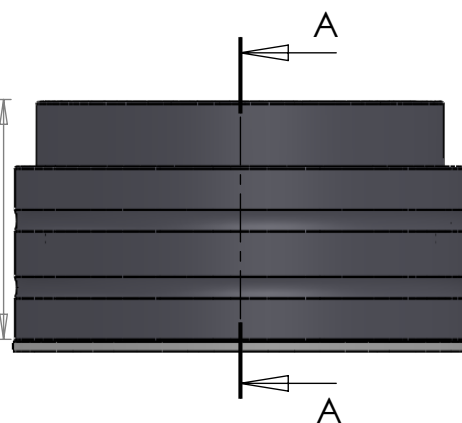

1



2



3



4



5



4



3



6



7



8



9



10

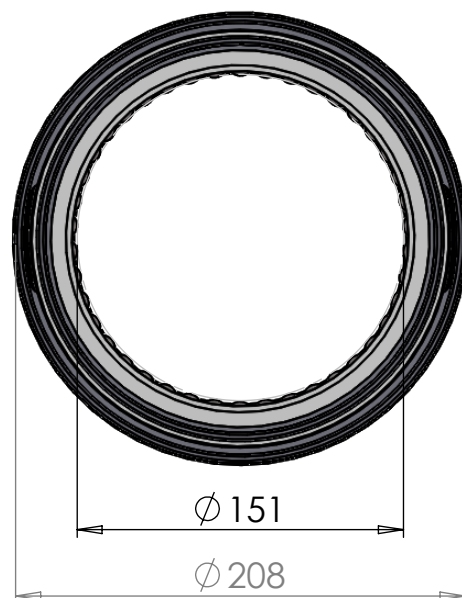

ITEM NO.	PART NUMBER	PART NAME	QTY.
1	M35-123	Inner house 4S150-4S159	1
2	O-ring	$\varnothing 170 \times 2.5$	1
3	M03-315	Delrin Lockring $\varnothing 178,5 \times \varnothing 161 \times 1,75\text{mm}$	2
4	M05-353	L-ring $\varnothing 155 \varnothing 158 \varnothing 175$	2
5	M01-364	Roller $\varnothing 12.0 \times 57\text{mm}$	42
6	M11-111	Ball 4S140-4S159	1
7	O-ring	$\varnothing 180 \times 2,5$	1
8	M09-125	Alu lockring $\varnothing 180.5 \times \varnothing 189.5$	1
9	M31-126	Outer house 4S140-4S159	1
10	M07-232-C	Washer, delrin $\varnothing 153,5 \times \varnothing 210 \times 4,5\text{mm}$	1

DWG NR / NAME:

4S151 / Self-aligning lower bearing

BATCH NR:

PROJECT:

Shaft $\varnothing 151\text{mm}$, max working load 9300kg

REKV.NR / ORDRE NR:

DATE:

27-08-2009

NAME:

JR

SCALE / PAPER:

1:5 / A4

MATERIAL:

WEIGHT:

g

LOCATION:

ORDRE DATO:

MODIFY DATE:

: /

REV:

LEV.DATO:

Jefa Rudder
SYSTEMS

JEFA MARINE A/S
NIMBUSVEJ 2
2670 GREVE, DENMARK

Tlf: +45 4615 5210 & Fax: +45 46155208
Email: info@jefa.com www.jefa.com