

A

B

C

D

E

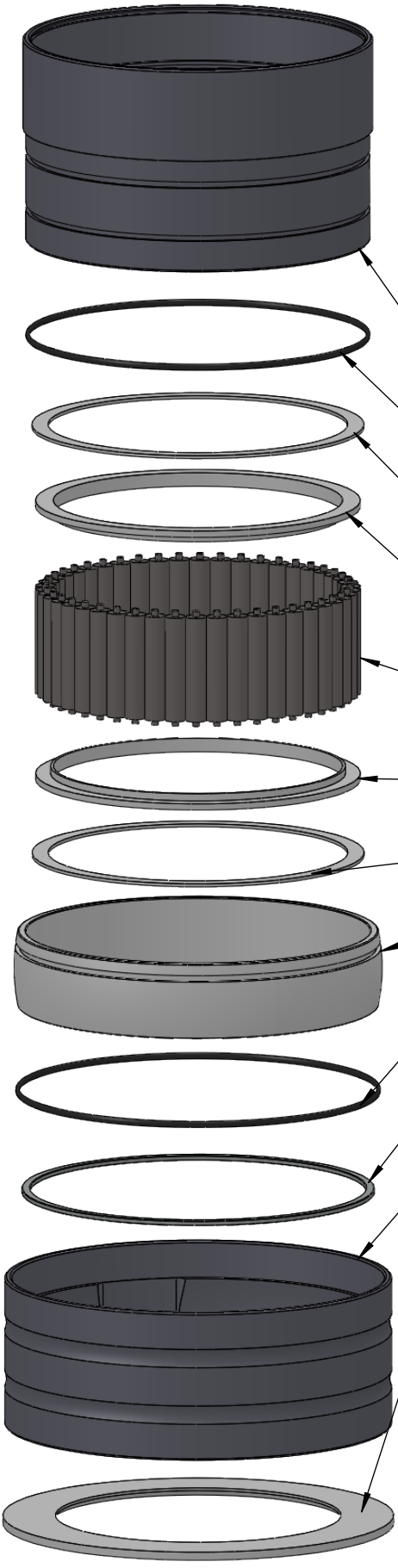
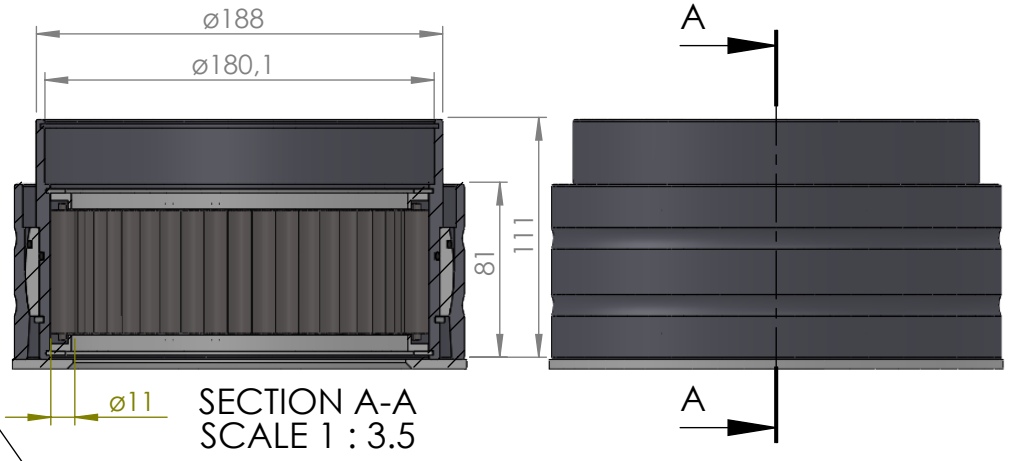

ITEM NO.	PART NUMBER	PART NAME	QTY
1	M35-123	Inner house 4S150-4S159	1
2	O-ring	$\varnothing 170 \times 2,5$	1
3	M03-315	Delrin Lockring $\varnothing 178,5 \times \varnothing 161 \times 1,75\text{mm}$	2
4	M05-353	L-ring $\varnothing 155 \varnothing 158 \varnothing 175$	2
5	M01-348	Roller $\varnothing 11.0 \times 57\text{mm}$	46
6	M11-111	Ball 4S140-4S159	1
7	O-ring	$\varnothing 180 \times 2,5$	1
8	M09-125	Alu lockring $\varnothing 180.5 \times \varnothing 189.5$	1
9	M31-126	Outer house 4S140-4S159	1
10	M07-232-C	Washer, delrin $\varnothing 153,5 \times \varnothing 210 \times 4,5\text{mm}$	1

DWG NR / NAME:

### 4S153 / Self-aligning lower bearing

BATCH NR:

PROJECT:  
Shaft  $\varnothing 153\text{mm}$ , max working load 9300kg

REKV.NR / ORDRE NR:

DATE:  
27-08-2009

NAME:  
JR

SCALE / PAPER:  
1:4 / A4

MATERIAL:  
WEIGHT: g

LOCATION:

ORDRE DATO:

MODIFY DATE:  
: /

REV:

LEV.DATO:



JEFA MARINE A/S  
NIMBUSVEJ 2  
2670 GREVE, DENMARK

Tlf: +45 4615 5210 & Fax: +45 4615208  
Email: info@jefa.com www.jefa.com