

SECTION A-A

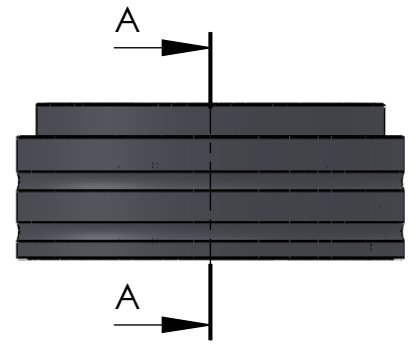

| ITEM NO. | PART NUMBER | PART NAME | QTY |
|----------|-------------|---|-----|
| 1 | O-ring | $\varnothing 260 \times 2.5$ | 1 |
| 2 | O-ring | $\varnothing 270 \times 2.5$ | 1 |
| 3 | M01-372 | Roller $\varnothing 12.5 \times 57\text{mm}$ | 60 |
| 4 | M03-795 | Delrin Lockring $\varnothing 258,5 \times \varnothing 241 \times 2,75\text{mm}$ | 2 |
| 5 | M05-405 | L-ring $\varnothing 235 \times \varnothing 255 \times 7,5\text{mm}$ | 2 |
| 6 | M09-170 | Alu lockring $\varnothing 266 \times \varnothing 278$ | 1 |
| 7 | M11-119 | Ball 4S220-4S239 | 1 |
| 8 | M31-146 | Outer house 4S220-4S239 | 1 |
| 9 | M35-139 | Inner house 4S230-4S239 | 1 |

DWG NR / NAME:

4S230 / Self-aligning lower bearing

BATCH NR:

PROJECT:

Shaft $\varnothing 230\text{mm}$, max working load 13100 kg

REKV.NR / ORDRE NR:

DATE:
08-10-2009NAME:
JRSCALE / PAPER:
1:6 / A4MATERIAL:
WEIGHT: g

LOCATION:

ORDRE DATO:

MODIFY DATE:

: /

REV:

LEV.DATO:

Jefa Rudder
SYSTEMS

JEFA MARINE A/S
NIMBUSVEJ 2
2670 GREVE, DENMARK

Tlf: +45 4615 5210 & Fax: +45 4615208
Email: info@jefa.com www.jefa.com