

SECTION A-A
SCALE 1 : 3

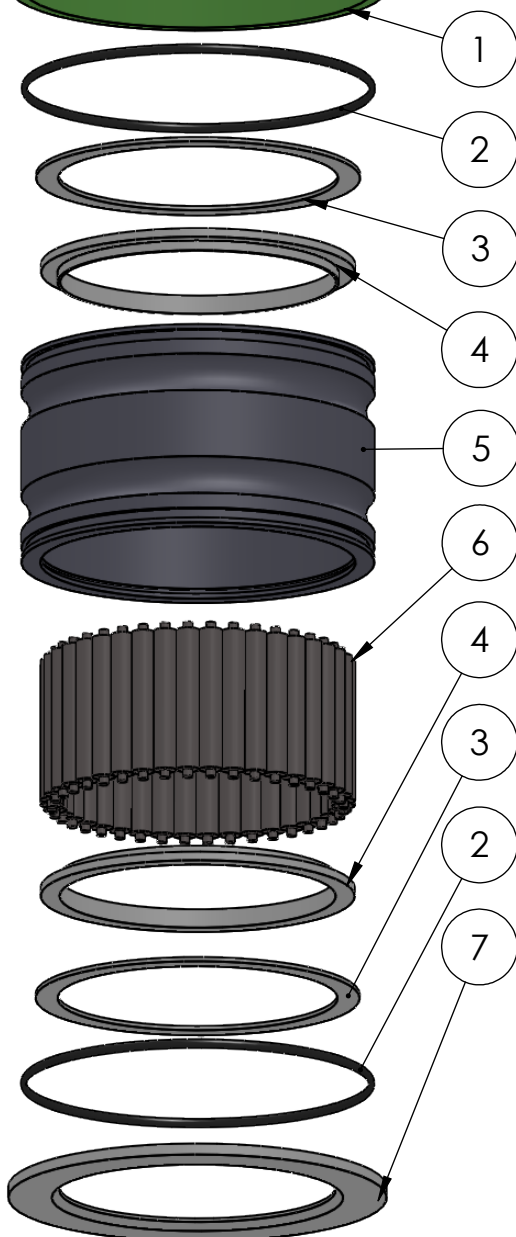
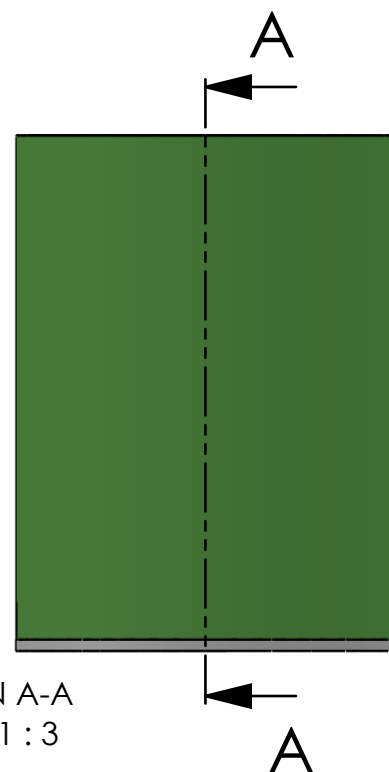

| ITEM NO. | PART NUMBER | PART NAME | QTY. |
|----------|---------------|--|------|
| 1 | GRP-TUBE-Ø150 | GRP tube Ø150 x Ø140 | 1 |
| 2 | O-ring | ø130 x 2.5 | 2 |
| 3 | M03-235 | Delrin Lockring ø128,5 x ø111 x 1,75mm | 2 |
| 4 | M05-266 | L-ring ø109 ø111.5 ø125 | 2 |
| 5 | M49-290 | House for 6S100-6S109 | 1 |
| 6 | M01-316 | Roller ø9.0 x 57mm | 40 |
| 7 | M07-196 | Washer, delrin ø110,5 x ø150 x 4,5mm | 1 |

DWG NR / NAME:

61107150 / GRP bottom roller bearing

BATCH NR:

PROJECT:

Shaft Ø107mm, max working load 4900-6200kg

REKV.NR / ORDRE NR:

DATE:

03.03.2016

NAME:

JR

SCALE / PAPER:

1:3 / A4

MATERIAL:

WEIGHT:

g

LOCATION:

REV:

ORDRE DATO:

LEV.DATO:

MODIFY DATE:

: /

Jefa Rudder
SYSTEMS

JEFA MARINE A/S
NIMBUSVEJ 2
2670 GREVE, DENMARK

Tlf: +45 4615 5210 & Fax: +45 4615 5208
Email: info@jefa.com www.jefa.com