

SECTION A-A  
SCALE 1 : 2

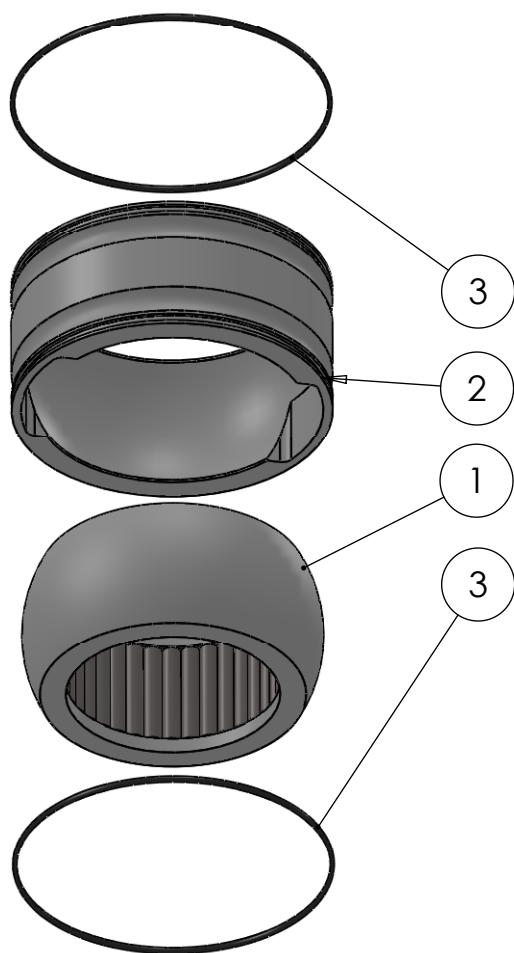

| ITEM NO. | PART NUMBER | PART NAME                                                            | Default/ QTY. |
|----------|-------------|----------------------------------------------------------------------|---------------|
| 1        | M13-464-113 | Ball with rollers                                                    | 1             |
| 2        | M48-165     | House $\varnothing 170\text{mm}$ for $\varnothing 160\text{mm}$ ball | 1             |
| 3        | O-ring      | $\varnothing 166 \times 2.5$                                         | 2             |

DWG NR / NAME:

6BB170113 / S-A bottom Roller bearing

BATCH NR:

PROJECT:

Shaft  $\varnothing 113\text{mm}$

REKV.NR / ORDRE NR:

DATE:

31.01.2012

NAME:

JR

SCALE / PAPER:

1:4 / A4

MATERIAL:

WEIGHT:

g

LOCATION:

REV:

ORDRE DATO:

LEV.DATO:

MODIFY DATE:

: /

*Jefa Rudder*  
SYSTEMS

JEFA MARINE A/S  
NIMBUSVEJ 2  
2670 GREVE, DENMARK

Tlf: +45 4615 5210 & Fax: +45 4615208  
Email: info@jefa.com www.jefa.com