

1. Disconnect any universal joint, keys or other, which is mounted on the shaft beneath the pedestal.

2. Unscrew 3pcs screws to dismount the cover plate.

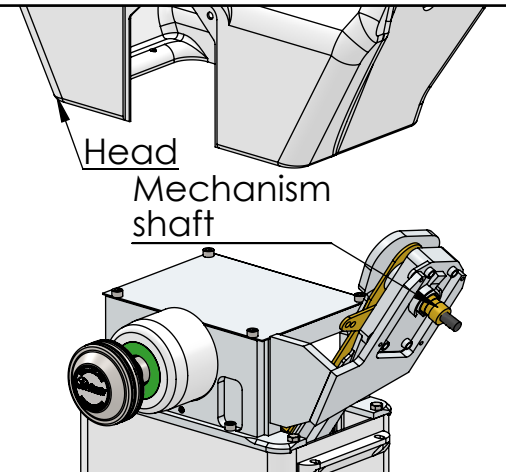
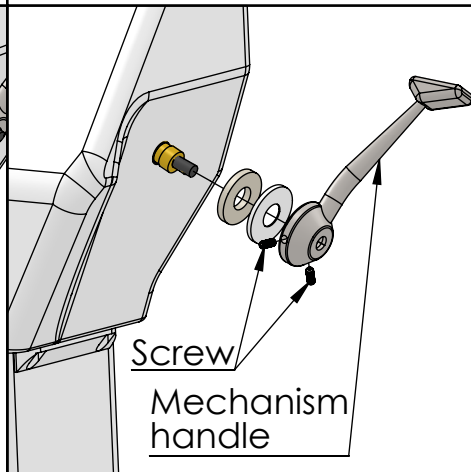
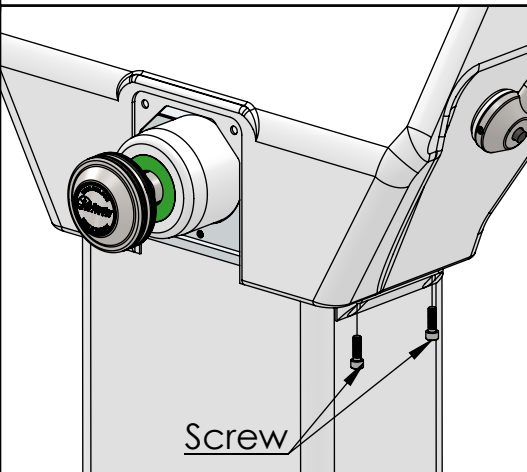

3. Unscrew 4pcs screw to loosen the GRP head. (2 screws on each side of the pedestal)

4. Unscrew 2pcs screw to dismount the mechanism handle.

5. Lift the head a few centimeters and tilt the top towards the mechanism shaft. When the shaft disappears in the head, carefully continue to pull upwards.

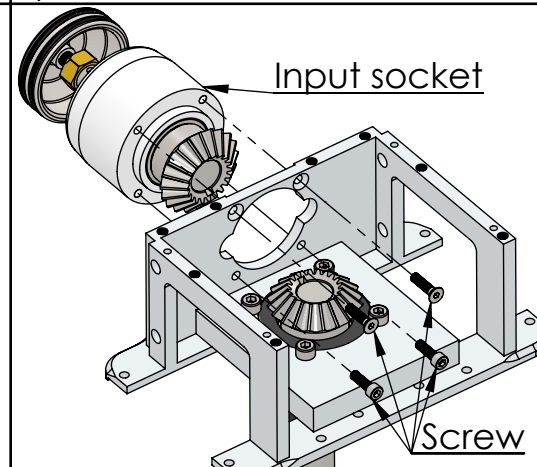
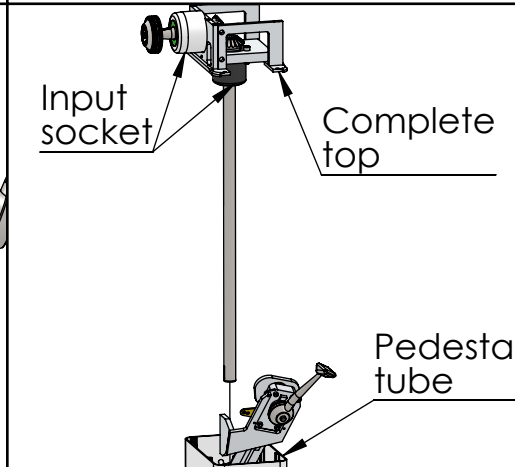
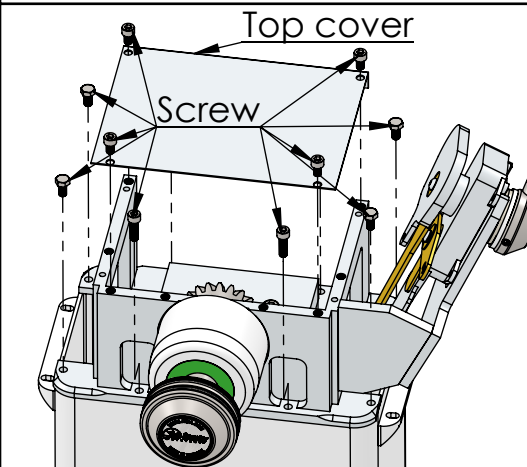

6. Unscrew 4pcs screw to remove the top cover. Unscrew 8pcs of screw to loosen the pedestal top, then unscrew 2pcs screw to dismount the engine control bracket.

7. Lift the complete top with shaft and input sockets up and out of the pedestal tube.

8. Unscrew 4pcs of screw to dismount the input socket.

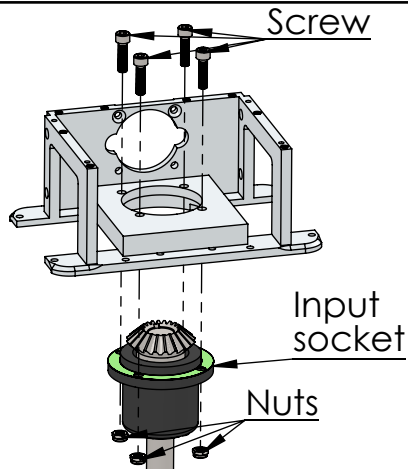

9. Unscrew 4pcs screw and nuts to dismount the input socket with shaft.

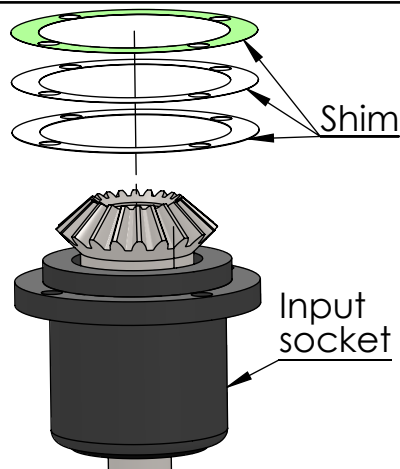

10. The shims are now revealed.

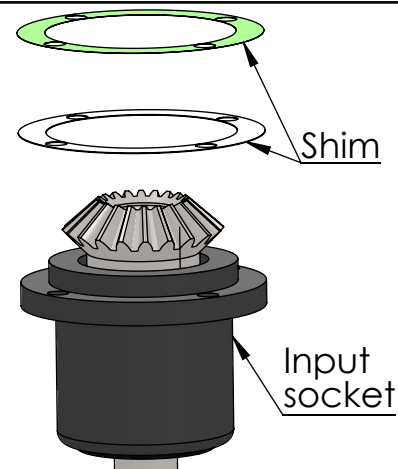

11. Reduce thickness between the input socket and the pedestal top frame by removing only one shim.

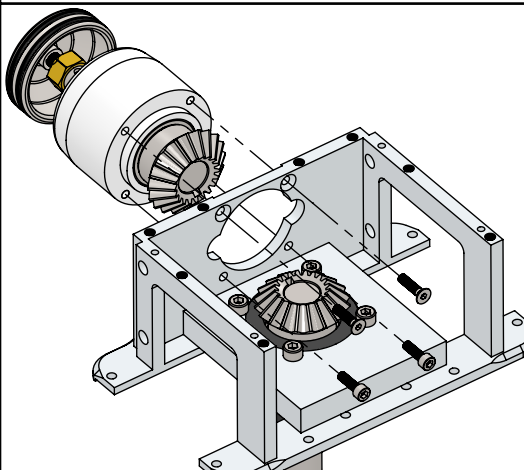

12. Mount both of the input sockets on pedestal top. If there is still play between the gears, go back to picture 8. It's allowed to have a bit toothy feeling when rotating the shaft.

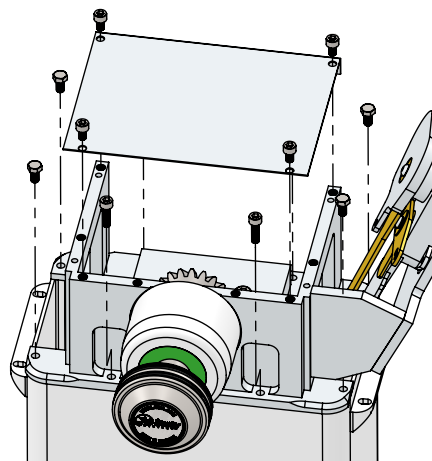

13. Put the long shaft through the bearing in the bottom of the pedestal. Mount 8pcs screw on pedestal top, and 2pcs screw for the engine control bracket, and 4pcs screw for the top cover.

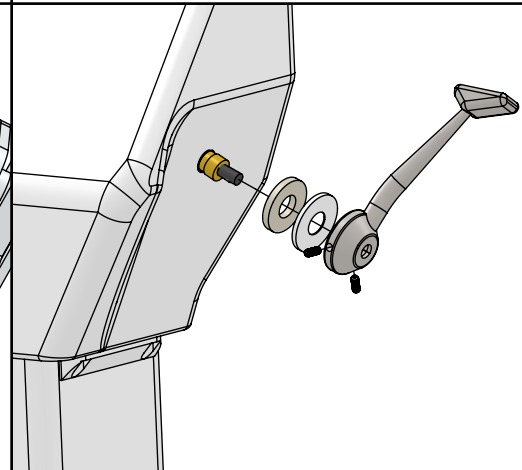

14. Carefully mount the head on the pedestal, then mount the 4 screws and tighten. Mount engine control handle and the 2pcs of screw.

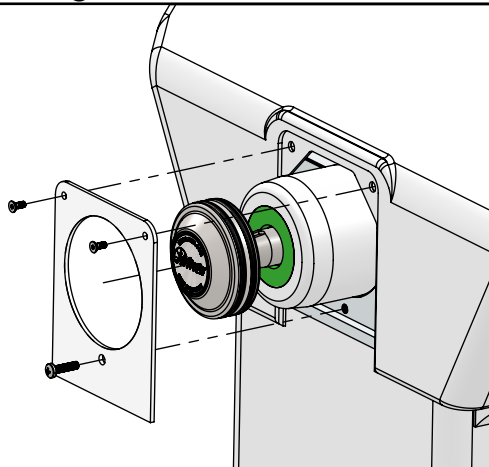

15. Mount the cover plate for input socket, and the 3pcs of screw as shown on the picture.

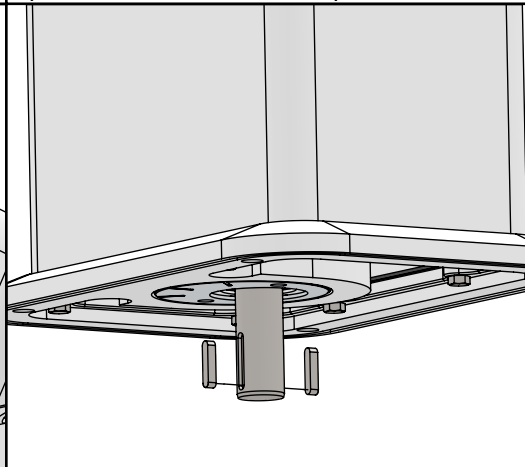

16. Connect universal joint with keys below the pedestal. The maintenance is finished.

